

SECTION 13.

# **PUSH BAR**

## PUSH BAR FOR TYPE 4206, 4205, 4201

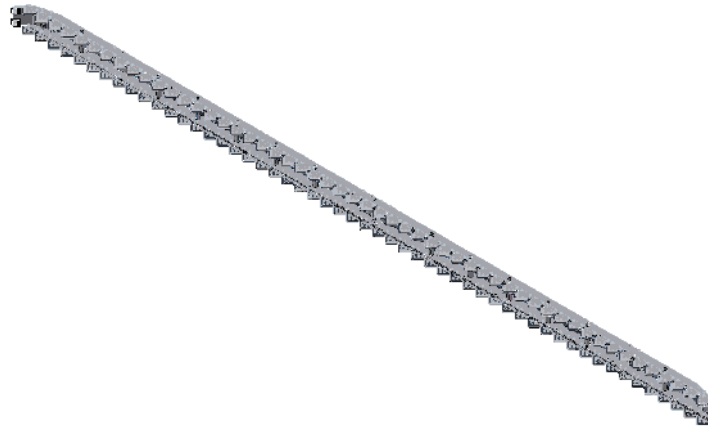

Push bars are manufactured according to the customers' needs. A distinction is made between metal sheet and push bars. The metal sheet platings on the push bar are either equipped with VA or CFC (cerberite) guidings. The push bar heights: 40, 50, 60, 70, 80, 90, 100, 110, 120, 140, 160 are fixed dimensions.

Variable dimensions are:

- CD**
- Row number (R)**
- Angle (°) (Angle of Sheet)**
- Symmetrically or in 2 parts**
- Metal sheet platings**